

RV SERIES



PE
97/23/EC

E24.54.815.G (PSA-Renault)
VDI 3003

Minima altezza, massima forza - Miniature height, maximum force -
Minimale Höhe, maximale Leistung/Hauteur -
Minima altura, máxima fuerza - Altura mínima, força máxima

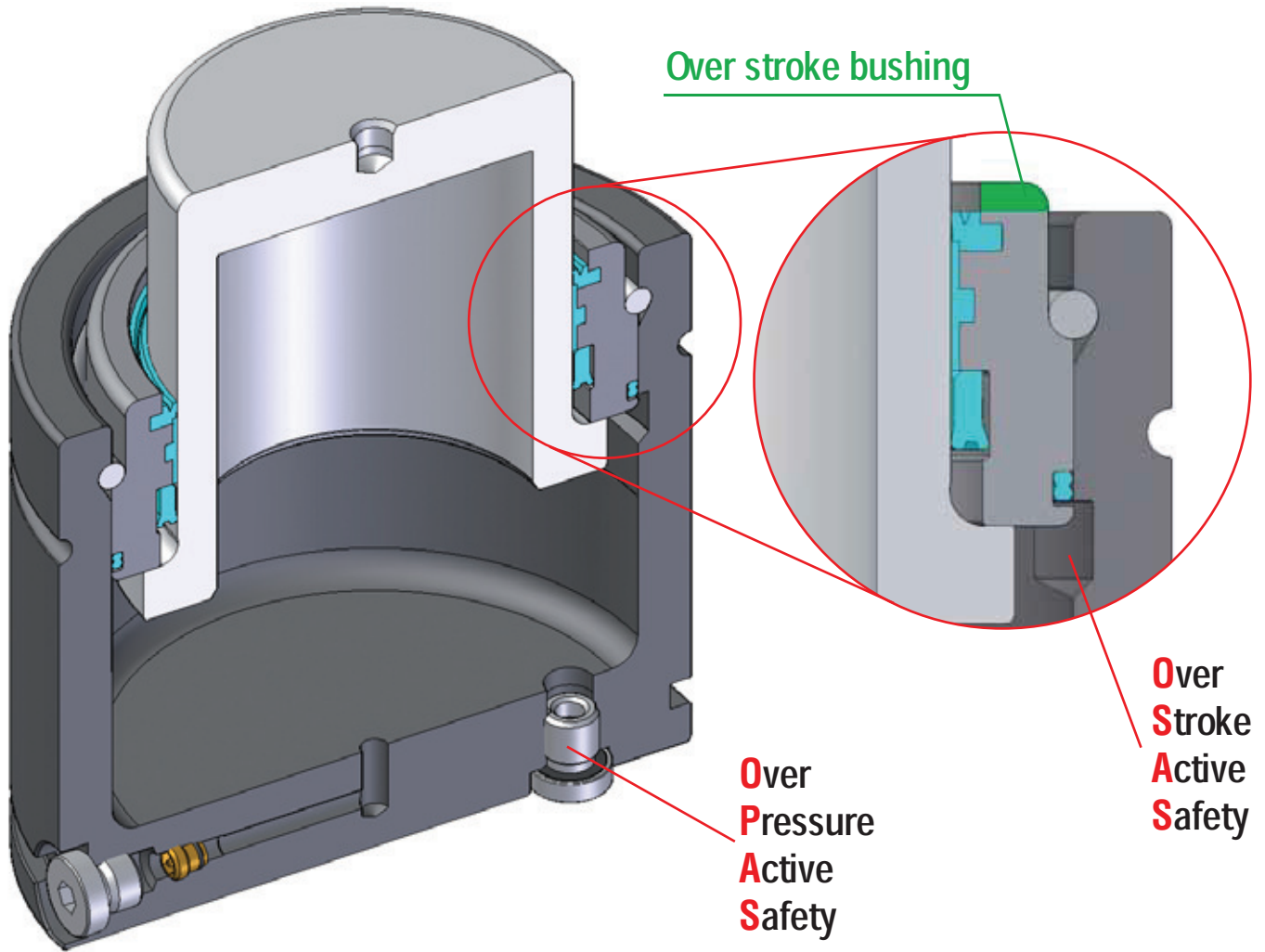

Range chart

Model	Body Ø		Stroke Cu		Initial force				
	mm	inch	mm	inch	daN	lb	SKUDO	OSAS	OPAS
RV 170	19	0,75	7 - 125	0,28 - 4,92	170	382	-	-	✓
RV 320	25	0,98	7 - 125	0,28 - 4,92	320	719	-	-	✓
RV 350	32	1,26	10 - 125	0,39 - 4,92	360	809	-	✓	-
RV 500	38	1,50	10 - 125	0,39 - 4,92	470	1057	-	✓	-
RV 750	45	1,77	10 - 125	0,39 - 4,92	740	1664	-	✓	-
RV 1000	50	1,97	10 - 125	0,39 - 4,92	920	2068	-	✓	-
RV 1200	50	1,97	10 - 125	0,39 - 4,92	1060	2383	-	✓	-
RV 1500	63	2,48	10 - 125	0,39 - 4,92	1530	3440	-	✓	-
RV 2400	75	2,95	10 - 125	0,39 - 4,92	2385	5362	-	✓	-
RV 4200	95	3,74	16 - 125	0,63 - 4,92	4240	9532	-	✓	✓
RV 6600	120	4,72	16 - 125	0,63 - 4,92	6630	14905	-	✓	✓
RV 9500	150	5,91	19 - 125	0,75 - 4,92	9540	21447	-	✓	✓

RV + Skudo

PED
97/23/EC

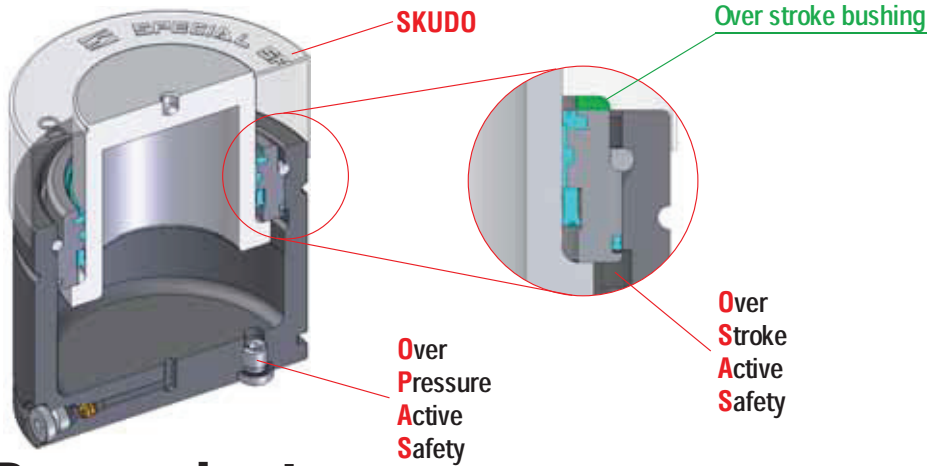

RV
RS-RF

Range chart

Model	Body Ø		Stroke Cu		Initial force				
	mm	inch	mm	inch	daN	lb	SKUDO	OSAS	OPAS
RS 170	19	0,75	7 - 122	0,28 - 4,80	170	382	✓	-	✓
RS 320	25	0,98	7 - 122	0,28 - 4,80	320	719	✓	-	✓
RS 350	32	1,26	7 - 122	0,28 - 4,80	360	809	✓	✓	-
RS 500	38	1,50	7 - 122	0,28 - 4,80	470	1057	✓	✓	-
RS 750	45	1,77	7 - 122	0,28 - 4,80	740	1664	✓	✓	-
RS 1000	50	1,97	10 - 122	0,39 - 4,80	920	2068	✓	✓	-
RS 1200	50	1,97	10 - 122	0,39 - 4,80	1060	2383	✓	✓	-
RS 1500	63	2,48	10 - 122	0,39 - 4,80	1530	3440	✓	✓	-
RS 2400	75	2,95	13 - 122	0,51 - 4,80	2385	5362	✓	✓	-
RS 4200	95	3,74	13 - 122	0,51 - 4,80	4240	9532	✓	✓	✓
RS 6600	120	4,72	13 - 122	0,51 - 4,80	6630	14905	✓	✓	✓
RS 9500	150	5,91	16 - 122	0,63 - 4,80	9540	21447	✓	✓	✓

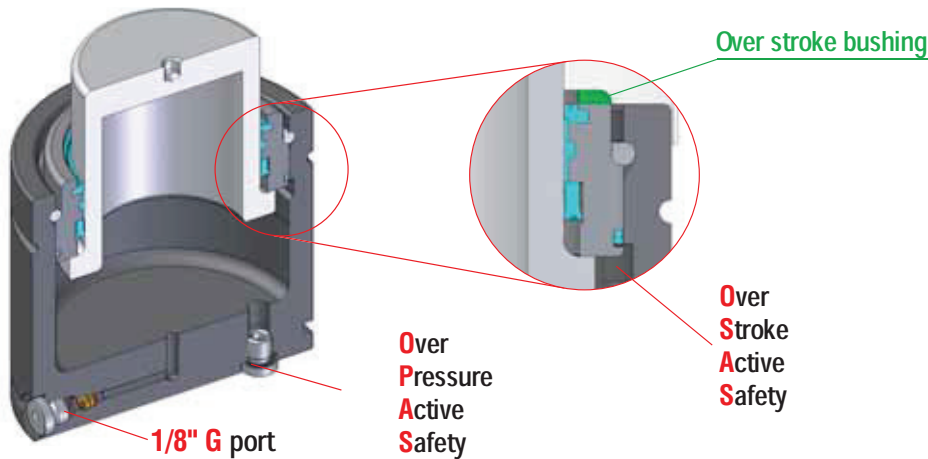

SERIES RF-RV

1/8" G

FIAT Specification

PED
97/23/EC

Model	Body Ø		Stroke Cu		Initial force				
	mm	inch	mm	inch	daN	lb	SKUDO	OSAS	OPAS
RF 750	45	1,77	10 - 125	0,39 - 4,92	740	1664	-	✓	✓
RF 1000	50	1,97	13 - 125	0,51 - 4,92	920	2068	-	✓	✓
RF 1200	50	1,97	13 - 125	0,51 - 4,92	1060	2383	-	✓	✓
RF 1500	63	2,48	13 - 125	0,51 - 4,92	1530	3440	-	✓	✓
RF 2400	75	2,95	16 - 125	0,63 - 4,92	2385	5362	-	✓	✓
RV 4200	95	3,74	16 - 125	0,63 - 4,92	4240	9532	-	✓	✓
RV 6600	120	4,72	16 - 125	0,63 - 4,92	6630	14905	-	✓	✓
RV 9500	150	5,91	19 - 125	0,75 - 4,92	9540	21447	-	✓	✓

RV 170



PED
97/23/EC

E24.54.815.G (PSA-Renault)
VDI 3003

Minima altezza, massima forza - Miniature height, maximum force -
Minimale Höhe, maximale Leistung - Hauteur -
Minima altura, máxima fuerza - Altura mínima, fuerza máxima

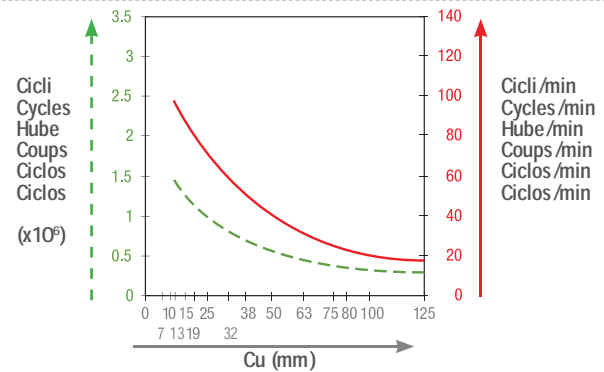
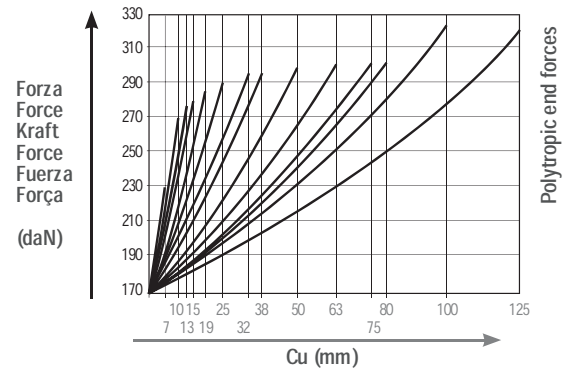
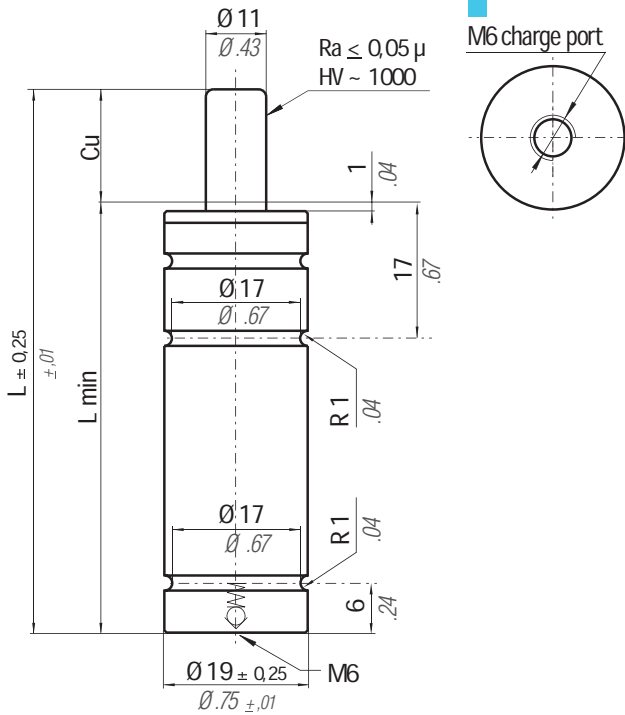

Max Speed 1,8m/s	°F 32 - 176	°C 0 - 80	N ₂	P max 180bar 2610 psi	P min 20bar 290 psi	S 0,95 cm ² 0,147 in ²		Maintenance kit Disposable	
----------------------------	----------------------	--------------------	----------------	------------------------------------	----------------------------------	---	--	--------------------------------------	--

CODE	Cu		L		L min		Fo		Vo		CODE		
	mm	inch	mm	inch	mm	inch	daN	lb	cm ³	in ³	~Kg	~lb	
RV 170 - 007 - A	7	0,28	44	1,73	37	1,46	170	382	3,1	0,19	0,057	0,13	RV 170 - 007 - A - N
RV 170 - 010 - A	10	0,39	50	1,97	40	1,57			4,0	0,24	0,061	0,13	RV 170 - 010 - A - N
RV 170 - 013 - A	13	0,51	56	2,20	43	1,69			5,0	0,31	0,065	0,14	RV 170 - 013 - A - N
RV 170 - 015 - A	15	0,59	60	2,36	45	1,77			5,6	0,34	0,066	0,15	RV 170 - 015 - A - N
RV 170 - 019 - A	19	0,75	68	2,68	49	1,93			6,9	0,42	0,071	0,16	RV 170 - 019 - A - N
RV 170 - 025 - A	25	0,98	80	3,15	55	2,17			8,8	0,54	0,078	0,17	RV 170 - 025 - A - N
RV 170 - 032 - A	32	1,26	94	3,70	62	2,44			11,0	0,67	0,086	0,19	RV 170 - 032 - A - N
RV 170 - 038 - A	38	1,50	106	4,17	68	2,68			12,9	0,79	0,093	0,21	RV 170 - 038 - A - N
RV 170 - 050 - A	50	1,97	130	5,12	80	3,15			16,7	1,02	0,107	0,24	RV 170 - 050 - A - N
RV 170 - 063 - A	63	2,48	156	6,14	93	3,66			20,9	1,27	0,121	0,27	RV 170 - 063 - A - N
RV 170 - 075 - A	75	2,95	185	7,28	110	4,33			24,7	1,51	0,139	0,31	RV 170 - 075 - A - N
RV 170 - 080 - A	80	3,15	195	7,68	115	4,53			26,3	1,60	0,145	0,32	RV 170 - 080 - A - N
RV 170 - 100 - A	100	3,94	235	9,25	135	5,31			29,8	1,82	0,166	0,37	RV 170 - 100 - A - N
RV 170 - 125 - A	125	4,92	285	11,22	160	6,30			37,8	2,31	0,194	0,43	RV 170 - 125 - A - N

Info pg. 231

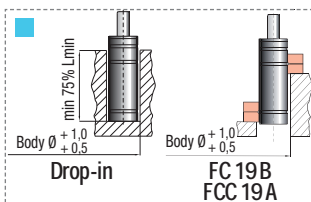

HOW TO ORDER

(10 pcs) RV 170-050-A
(10 pcs) RV 170-050-A-N

RV 320

PED
97/23/EC



Minima altezza, massima forza - Miniature height, maximum force -
Minimale Höhe, maximale Leistung/Hauteur -
Minima altura, máxima fuerza - Altura mínima, fuerza máxima

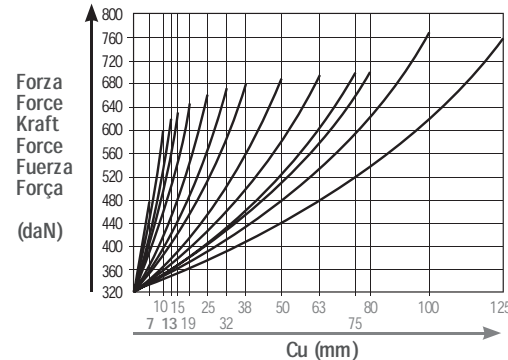
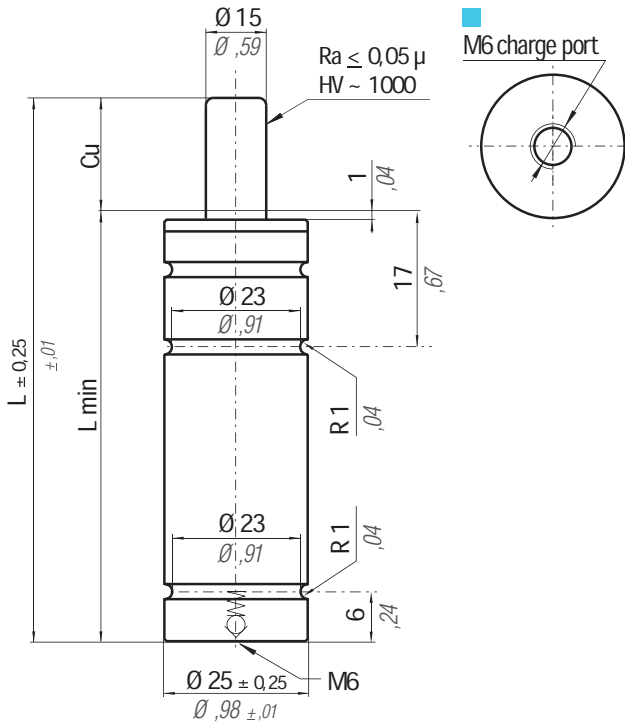

Polytropic end forces

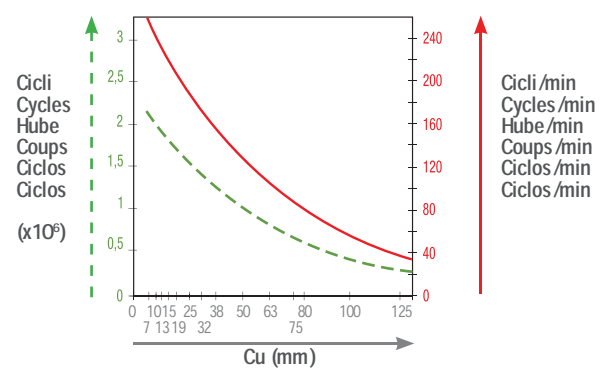

Max Speed 1,8m/s	°F 32 °C 0	°C 80		P max 180bar 2610 psi	P min 20bar 290 psi	S 1,77 cm ² 0,27 in ²		Maintenance kit Disposable	
----------------------------	---------------	-------	--	------------------------------------	----------------------------------	--	--	--------------------------------------	--

CODE	Cu		L		L min		Fo		Vo		CODE		
	mm	inch	mm	inch	mm	inch	daN	lb	cm ³	in ³	~Kg	~lb	
RV 320-007-A	7	0,28	44	1,73	37	1,46	320	719	4,3	0,26	0,099	0,22	RV 320-007-A-N
RV 320-010-A	10	0,39	50	1,97	40	1,57			5,6	0,34	0,104	0,23	RV 320-010-A-N
RV 320-013-A	13	0,51	56	2,20	43	1,69			7,0	0,43	0,108	0,24	RV 320-013-A-N
RV 320-015-A	15	0,59	60	2,36	45	1,77			7,9	0,48	0,112	0,25	RV 320-015-A-N
RV 320-019-A	19	0,75	68	2,68	49	1,93			9,7	0,59	0,120	0,26	RV 320-019-A-N
RV 320-025-A	25	0,98	80	3,15	55	2,17			12,4	0,76	0,130	0,29	RV 320-025-A-N
RV 320-032-A	32	1,26	94	3,70	62	2,44			15,6	0,95	0,140	0,31	RV 320-032-A-N
RV 320-038-A	38	1,50	106	4,17	68	2,68			18,3	1,12	0,151	0,33	RV 320-038-A-N
RV 320-050-A	50	1,97	130	5,12	80	3,15			23,8	1,45	0,171	0,38	RV 320-050-A-N
RV 320-063-A	63	2,48	156	6,14	93	3,66			29,7	1,81	0,193	0,43	RV 320-063-A-N
RV 320-075-A	75	2,95	185	7,28	110	4,33			35,1	2,14	0,217	0,48	RV 320-075-A-N
RV 320-080-A	80	3,15	195	7,68	115	4,53			37,4	2,28	0,226	0,50	RV 320-080-A-N
RV 320-100-A	100	3,94	235	9,25	135	5,31			42,7	2,60	0,260	0,57	RV 320-100-A-N
RV 320-125-A	125	4,92	285	11,22	160	6,30			54,0	3,29	0,301	0,66	RV 320-125-A-N

Info pg. 231

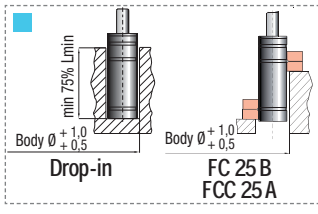

HOW TO ORDER

(10 pcs) RV 320-050-A
(10 pcs) RV 320-050-A-N

RV 350

PED
97/23/EC

E24.54.815.G (PSA-Renault)
VDI 3003



Minima altezza, massima forza - Miniature height, maximum force -
Minimale Höhe, maximale Leistung - Hauteur -
Minima altura, máxima fuerza - Altura mínima, fuerza máxima

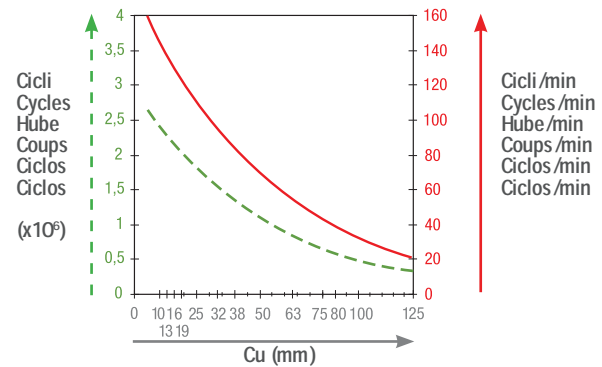
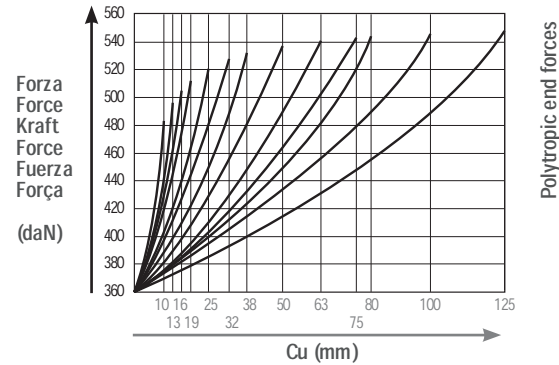
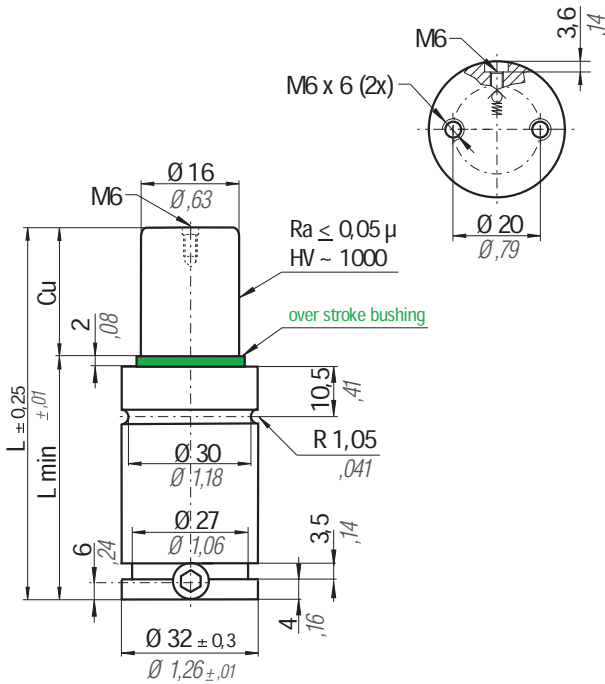

Max Speed 1,8m/s	°F 32 176	°C 0 80		P max 180bar 2610 psi	P min 20bar 290 psi	S 2,01 cm ² 0,312 in ²		Maintenance kit 39BMRV00350A	
----------------------------	------------------------	----------------------	--	------------------------------------	----------------------------------	---	--	--	--

CODE	Cu		L		L min		Fo		Vo		CODE		
	mm	inch	mm	inch	mm	inch	daN	lb	cm ³	in ³	~Kg	~lb	
RV 350 - 010 - A	10	0,39	50	1,97	40	1,57	360	809	7,8	0,48	0,162	0,36	RV 350 - 010 - A - N
RV 350 - 013 - A	13	0,51	56	2,20	43	1,69			9,7	0,59	0,173	0,38	RV 350 - 013 - A - N
RV 350 - 016 - A	16	0,63	62	2,44	46	1,81			11,6	0,71	0,182	0,40	RV 350 - 016 - A - N
RV 350 - 019 - A	19	0,75	68	2,68	49	1,93			13,4	0,82	0,191	0,42	RV 350 - 019 - A - N
RV 350 - 025 - A	25	0,98	80	3,15	55	2,17			17,2	1,05	0,209	0,46	RV 350 - 025 - A - N
RV 350 - 032 - A	32	1,26	94	3,70	62	2,44			21,6	1,32	0,230	0,51	RV 350 - 032 - A - N
RV 350 - 038 - A	38	1,50	106	4,17	68	2,68			25,3	1,54	0,249	0,55	RV 350 - 038 - A - N
RV 350 - 050 - A	50	1,97	130	5,12	80	3,15			32,8	2,00	0,285	0,63	RV 350 - 050 - A - N
RV 350 - 063 - A	63	2,48	156	6,14	93	3,66			41,0	2,50	0,325	0,72	RV 350 - 063 - A - N
RV 350 - 075 - A	75	2,95	180	7,09	105	4,13			48,5	2,96	0,361	0,80	RV 350 - 075 - A - N
RV 350 - 080 - A	80	3,15	190	7,48	110	4,33	51,6	3,15	0,375	0,83	RV 350 - 080 - A - N		
RV 350 - 100 - A	100	3,94	230	9,06	130	5,12	64,1	3,91	0,437	0,96	RV 350 - 100 - A - N		
RV 350 - 125 - A	125	4,92	280	11,02	155	6,10	79,8	4,87	0,513	1,13	RV 350 - 125 - A - N		

Info pg. 231

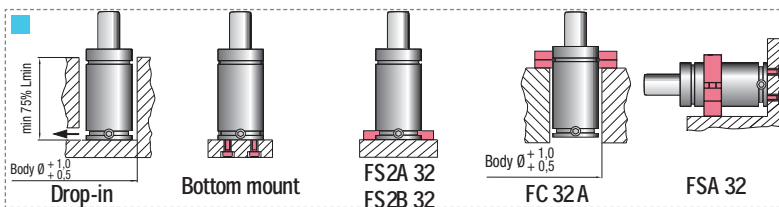

HOW TO ORDER

(10 pcs) RV 350-050-A
(10 pcs) RV 350-050-A-N

RV 500



E24.54.815.G (PSA-Renault)
VDI 3003



Minima altezza, massima forza - Miniature height, maximum force -
Minimale Höhe, maximale Leistung - Hauteur -
Minima altura, máxima fuerza - Altura mínima, fuerza máxima

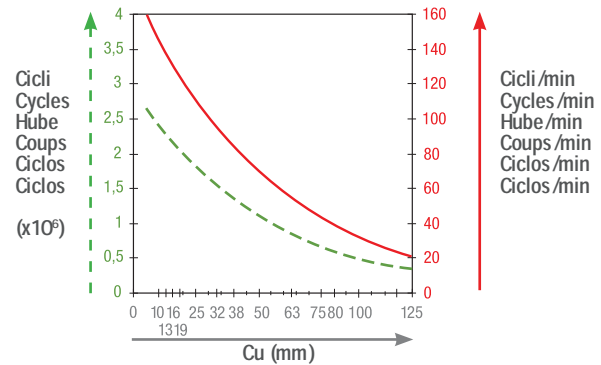
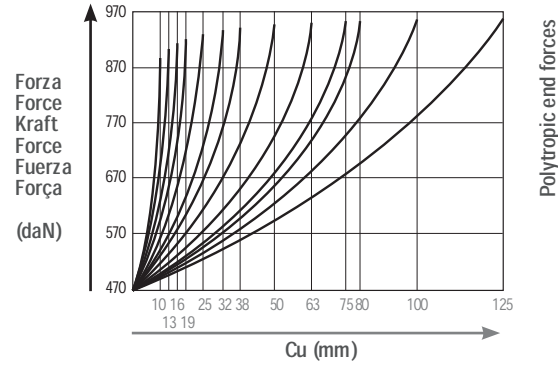
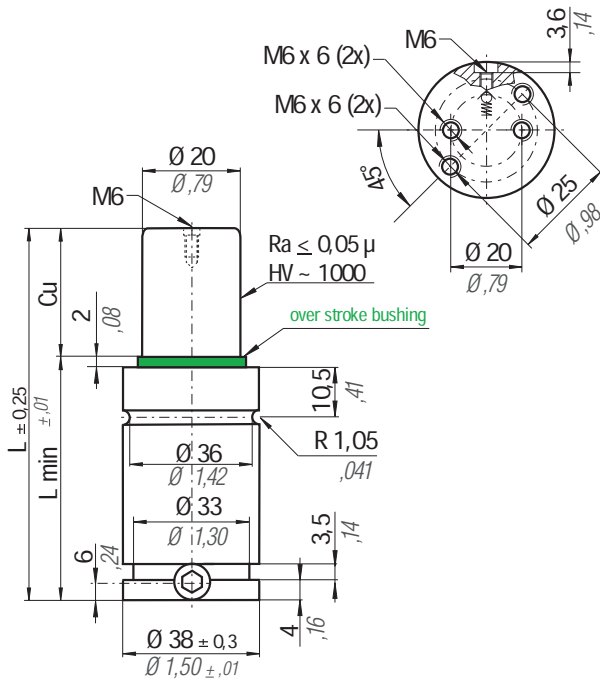

Max Speed 1,8m/s	°F 32 - 176	°C 0 - 80		P max 150bar 2175 psi	P min 20bar 290 psi	S 314cm ² 0,487 in ²		Maintenance kit 39BMRV00500A	
----------------------------	-----------------------------	---------------------------	--	------------------------------------	----------------------------------	---	--	--	--

CODE	Cu		L		L min		Fo		Vo		CODE		
	mm	inch	mm	inch	mm	inch	daN	lb	cm ³	in ³	~Kg	~lb	
RV 500 - 010 - A	10	0,39	50	1,97	40	1,57	470	1057	9,5	0,58	0,24	0,53	RV 500 - 010 - A - N
RV 500 - 013 - A	13	0,51	56	2,20	43	1,69			12,1	0,74	0,25	0,55	RV 500 - 013 - A - N
RV 500 - 016 - A	16	0,63	62	2,44	46	1,81			14,7	0,90	0,26	0,57	RV 500 - 016 - A - N
RV 500 - 019 - A	19	0,75	68	2,68	49	1,93			17,3	1,06	0,28	0,62	RV 500 - 019 - A - N
RV 500 - 025 - A	25	0,98	80	3,15	55	2,17			22,4	1,37	0,31	0,68	RV 500 - 025 - A - N
RV 500 - 032 - A	32	1,26	94	3,70	62	2,44			28,5	1,74	0,34	0,75	RV 500 - 032 - A - N
RV 500 - 038 - A	38	1,50	106	4,17	68	2,68			33,6	2,05	0,37	0,82	RV 500 - 038 - A - N
RV 500 - 050 - A	50	1,97	130	5,12	80	3,15			44,0	2,68	0,42	0,93	RV 500 - 050 - A - N
RV 500 - 063 - A	63	2,48	156	6,14	93	3,66			55,1	3,36	0,48	1,06	RV 500 - 063 - A - N
RV 500 - 075 - A	75	2,95	180	7,09	105	4,13			65,5	4,00	0,54	1,19	RV 500 - 075 - A - N
RV 500 - 080 - A	80	3,15	190	7,48	110	4,33	69,8	4,26	0,56	1,23	RV 500 - 080 - A - N		
RV 500 - 100 - A	100	3,94	230	9,06	130	5,12	87,0	5,31	0,66	1,46	RV 500 - 100 - A - N		
RV 500 - 125 - A	125	4,92	280	11,02	155	6,10	108,5	6,62	0,77	1,70	RV 500 - 125 - A - N		

Info pg. 231

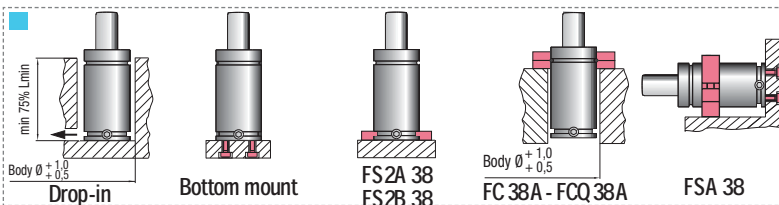

HOW TO ORDER

(10 pcs) RV 500-050-A
(10 pcs) RV 500-050-A-N

RV 750



E24.54.815.G (PSA-Renault)
VDI 3003



Minima altezza, massima forza - Miniature height, maximum force -
Minimale Höhe, maximale Leistung - Hauteur -
Minima altura, máxima fuerza - Altura mínima, fuerza máxima

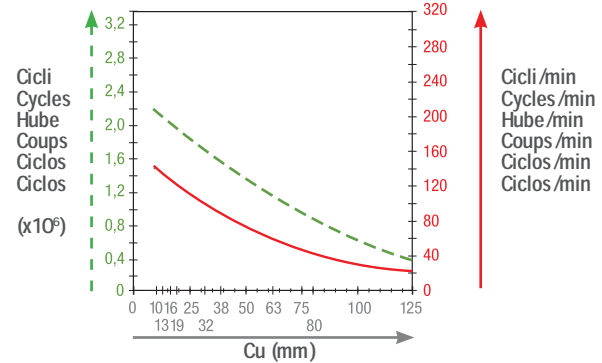
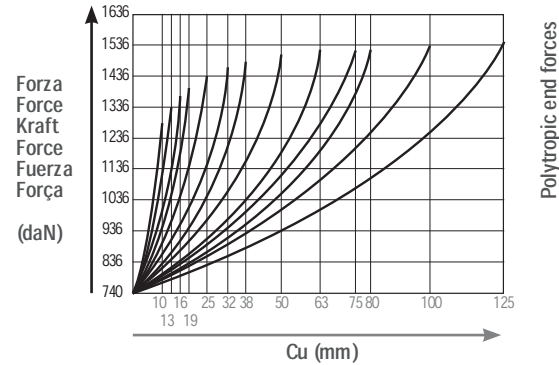
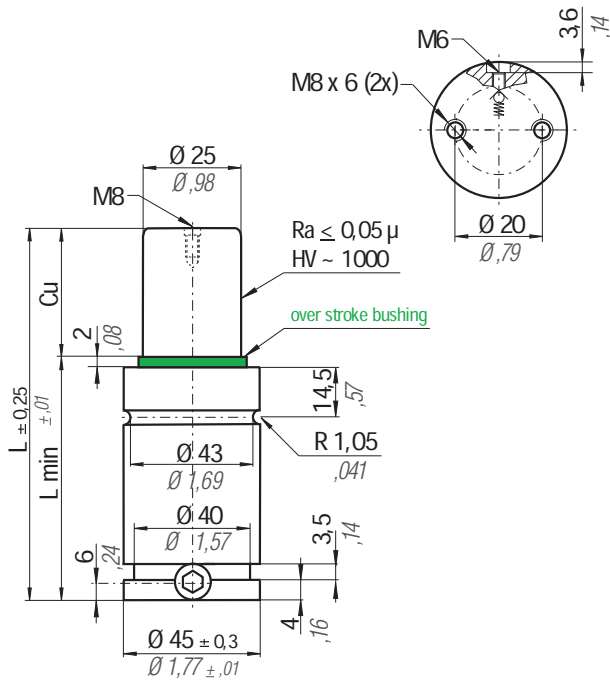

Max Speed 1,8m/s	°F 32 - 176	°C 0 - 80	N₂	P max 150bar 2175 psi	P min 20bar 290 psi	S 4,91 cm ² 0,761 in ²		Maintenance kit 39BMRV00750A	
----------------------------	-----------------------------	---------------------------	----------------------	------------------------------------	----------------------------------	---	--	--	--

CODE	Cu		L		L min		F ₀		V ₀		CODE		
	mm	inch	mm	inch	mm	inch	daN	lb	cm ³	in ³	~Kg	~lb	
RV 750 - 010 - A	10	0,39	52	2,05	42	1,65	740 1664 150bar 2175psi ± 5% + 20°C +68°F		16,5	1,01	0,36	0,79	RV 750 - 010 - A - N
RV 750 - 013 - A	13	0,51	58	2,28	45	1,77			20,4	1,24	0,38	0,84	RV 750 - 013 - A - N
RV 750 - 016 - A	16	0,63	64	2,52	48	1,89			24,2	1,48	0,39	0,86	RV 750 - 016 - A - N
RV 750 - 019 - A	19	0,75	70	2,76	51	2,01			28,0	1,71	0,41	0,90	RV 750 - 019 - A - N
RV 750 - 025 - A	25	0,98	82	3,23	57	2,24			35,6	2,17	0,45	0,99	RV 750 - 025 - A - N
RV 750 - 032 - A	32	1,26	96	3,78	64	2,52			44,5	2,71	0,50	1,10	RV 750 - 032 - A - N
RV 750 - 038 - A	38	1,50	108	4,25	70	2,76			52,2	3,18	0,54	1,19	RV 750 - 038 - A - N
RV 750 - 050 - A	50	1,97	132	5,20	82	3,23			67,4	4,11	0,61	1,34	RV 750 - 050 - A - N
RV 750 - 063 - A	63	2,48	158	6,22	95	3,74			84,0	5,12	0,70	1,54	RV 750 - 063 - A - N
RV 750 - 075 - A	75	2,95	182	7,17	107	4,21			100,3	6,12	0,77	1,70	RV 750 - 075 - A - N
RV 750 - 080 - A	80	3,15	192	7,56	112	4,41			106,6	6,50	0,81	1,79	RV 750 - 080 - A - N
RV 750 - 100 - A	100	3,94	232	9,13	132	5,20			132,1	8,06	0,93	2,05	RV 750 - 100 - A - N
RV 750 - 125 - A	125	4,92	282	11,10	157	6,18			163,9	10,00	1,10	2,43	RV 750 - 125 - A - N

Info pg. 231

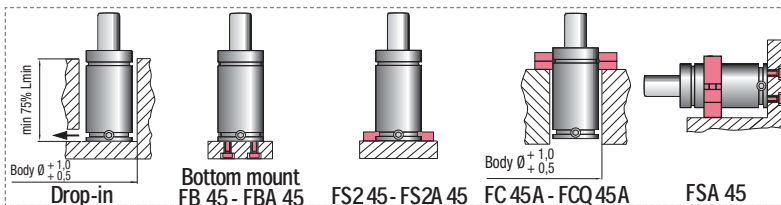

HOW TO ORDER

(10 pcs) RV 750-050-A
(10 pcs) RV 750-050-A-N

RV 1000



E24.54.815.G (PSA-Renault)
VDI 3003



Minima altezza, massima forza - Miniature height, maximum force -
Minimale Höhe, maximale Leistung/Hauteur -
Minima altura, máxima fuerza - Altura mínima, força máxima

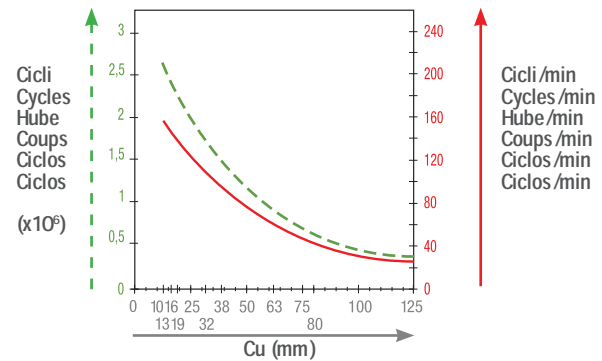
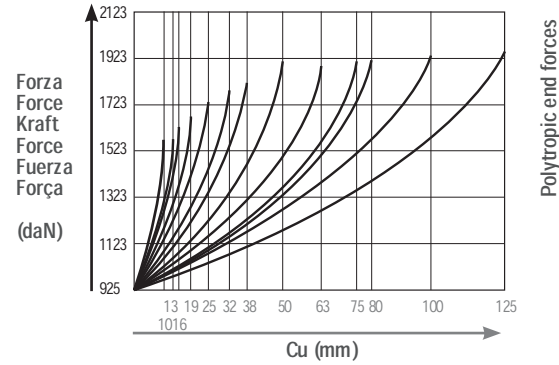
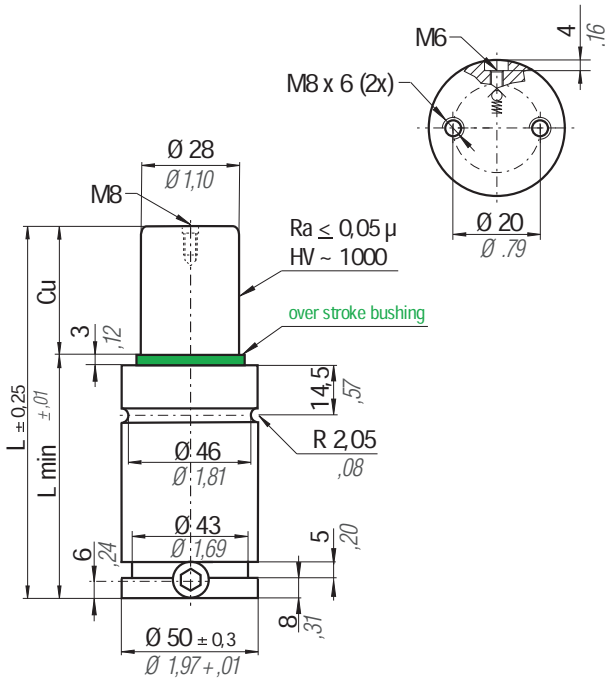

Max Speed 1,8m/s	°F 32 176	°C 0 -80		P max 150bar 2175 psi	P min 20bar 290 psi	S 6,15 cm ² 0,953 in ²		Maintenance kit 39BMRV01000A	
----------------------------	------------------------	-----------------------	--	------------------------------------	----------------------------------	---	--	--	--

CODE	Cu		L		L min		Fo		Vo		CODE		
	mm	inch	mm	inch	mm	inch	daN	lb	cm ³	in ³	~Kg	~lb	
RV 1000 - 010 - A	10	0,39	58	2,28	48	1,89	920 2068 150bar 2175 psi ± 5% + 20°C + 68°F		23,0	1,40	0,49	1,08	RV 1000 - 010 - A - N
RV 1000 - 013 - A	13	0,51	64	2,52	51	2,01			28,0	1,71	0,51	1,12	RV 1000 - 013 - A - N
RV 1000 - 016 - A	16	0,63	70	2,76	54	2,13			32,7	1,99	0,54	1,19	RV 1000 - 016 - A - N
RV 1000 - 019 - A	19	0,75	76	2,99	57	2,24			37,4	2,28	0,56	1,23	RV 1000 - 019 - A - N
RV 1000 - 025 - A	25	0,98	88	3,46	63	2,48			46,8	2,85	0,61	1,34	RV 1000 - 025 - A - N
RV 1000 - 032 - A	32	1,26	102	4,02	70	2,76			57,8	3,53	0,67	1,48	RV 1000 - 032 - A - N
RV 1000 - 038 - A	38	1,50	114	4,49	76	2,99			67,2	4,10	0,71	1,57	RV 1000 - 038 - A - N
RV 1000 - 050 - A	50	1,97	138	5,43	88	3,46			83,6	5,10	0,81	1,79	RV 1000 - 050 - A - N
RV 1000 - 063 - A	63	2,48	164	6,46	101	3,98			106,5	6,50	0,91	2,01	RV 1000 - 063 - A - N
RV 1000 - 075 - A	75	2,95	188	7,40	113	4,45			125,3	7,64	1,05	2,31	RV 1000 - 075 - A - N
RV 1000 - 080 - A	80	3,15	198	7,80	118	4,65			133,2	8,13	1,09	2,40	RV 1000 - 080 - A - N
RV 1000 - 100 - A	100	3,94	238	9,37	138	5,43			164,6	10,04	1,21	2,67	RV 1000 - 100 - A - N
RV 1000 - 125 - A	125	4,92	288	11,34	163	6,42	203,9	12,44	1,41	3,11	RV 1000 - 125 - A - N		

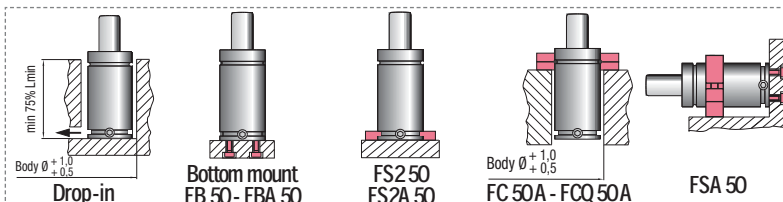

HOW TO ORDER

(10 pcs) RV 1000-050-A
(10 pcs) RV 1000-050-A-N

RV 1200

PED
97/23/EC



Minima altezza, massima forza - Miniature height, maximum force -
Minimale Höhe, maximale Leistung/Hauteur -
Minima altura, máxima fuerza - Altura mínima, força máxima

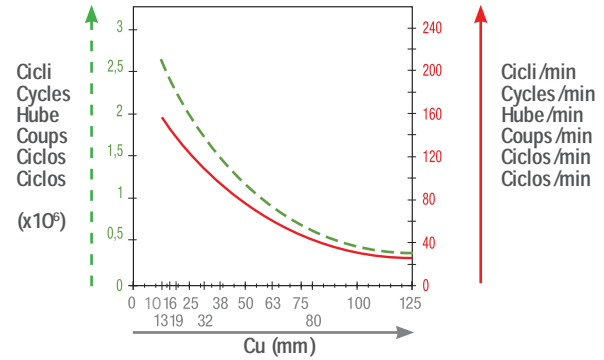
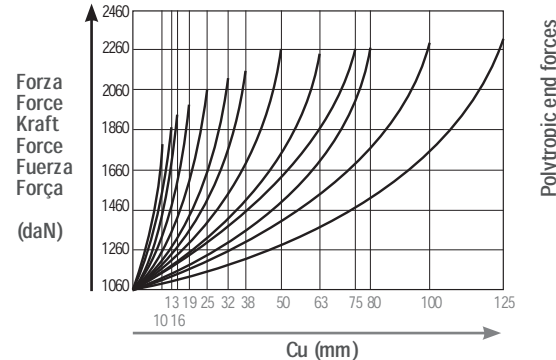
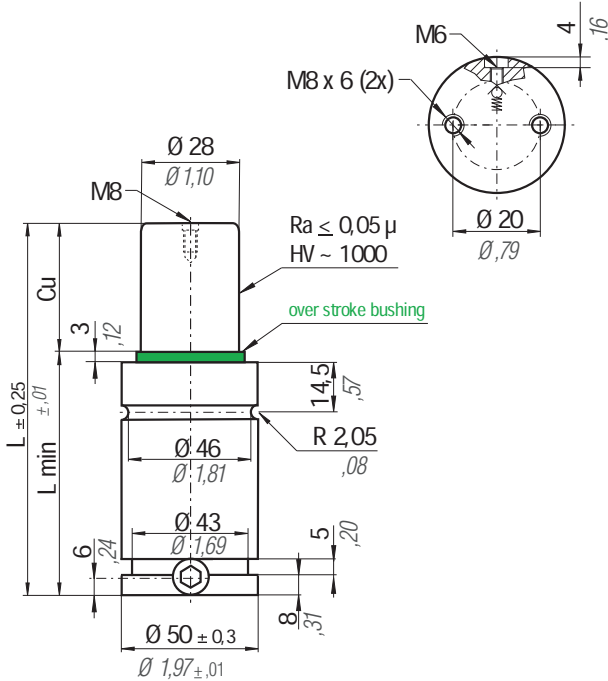

Max Speed 1,8m/s	°F 32 176	°C 0 80	N₂	P max 170bar 2465 psi	P min 20bar 290 psi	S 6,15 cm ² 0,953 in ²		Maintenance kit 39BMRV01000A	
----------------------------	------------------------	----------------------	----------------------	------------------------------------	----------------------------------	---	--	--	--

CODE	Cu		L		L min		F ₀		V ₀		CODE		
	mm	inch	mm	inch	mm	inch	daN	lb	cm ³	in ³	~Kg	~lb	
RV 1200 - 010 - A	10	0,39	58	2,28	48	1,89	1060	2383	23,0	1,40	0,49	1,08	RV 1200 - 010 - A - N
RV 1200 - 013 - A	13	0,51	64	2,52	51	2,01			28,0	1,71	0,51	1,12	RV 1200 - 013 - A - N
RV 1200 - 016 - A	16	0,63	70	2,76	54	2,13			32,7	1,99	0,54	1,19	RV 1200 - 016 - A - N
RV 1200 - 019 - A	19	0,75	76	2,99	57	2,24			37,4	2,28	0,56	1,23	RV 1200 - 019 - A - N
RV 1200 - 025 - A	25	0,98	88	3,46	63	2,48			46,8	2,85	0,61	1,34	RV 1200 - 025 - A - N
RV 1200 - 032 - A	32	1,26	102	4,02	70	2,76			57,8	3,53	0,67	1,48	RV 1200 - 032 - A - N
RV 1200 - 038 - A	38	1,50	114	4,49	76	2,99			67,2	4,10	0,71	1,57	RV 1200 - 038 - A - N
RV 1200 - 050 - A	50	1,97	138	5,43	88	3,46			83,6	5,10	0,81	1,79	RV 1200 - 050 - A - N
RV 1200 - 063 - A	63	2,48	164	6,46	101	3,98			106,5	6,50	0,91	2,01	RV 1200 - 063 - A - N
RV 1200 - 075 - A	75	2,95	188	7,40	113	4,45			125,3	7,64	1,05	2,31	RV 1200 - 075 - A - N
RV 1200 - 080 - A	80	3,15	198	7,80	118	4,65			133,2	8,13	1,09	2,40	RV 1200 - 080 - A - N
RV 1200 - 100 - A	100	3,94	238	9,37	138	5,43			164,6	10,04	1,21	2,67	RV 1200 - 100 - A - N
RV 1200 - 125 - A	125	4,92	288	11,34	163	6,42	203,9	12,44	1,41	3,11	RV 1200 - 125 - A - N		

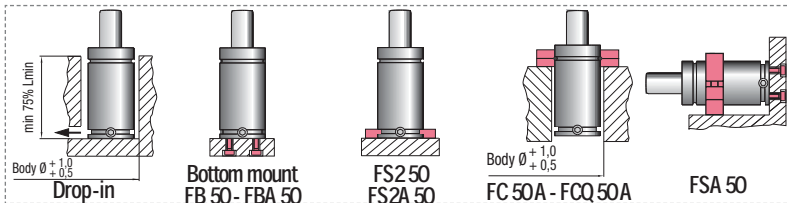

HOW TO ORDER
(10 pcs) RV 1200-050-A
(10 pcs) RV 1200-050-A-N

RV 1500



E24.54.815.G (PSA-Renault)
VDI 3003



Minima altezza, massima forza - Miniature height, maximum force -
Minimale Höhe, maximale Leistung - Hauteur -
Minima altura, máxima fuerza - Altura mínima, fuerza máxima

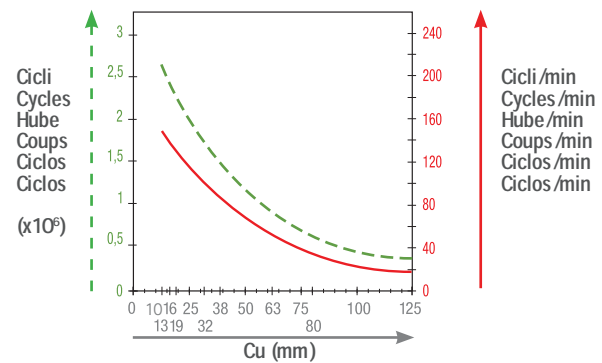
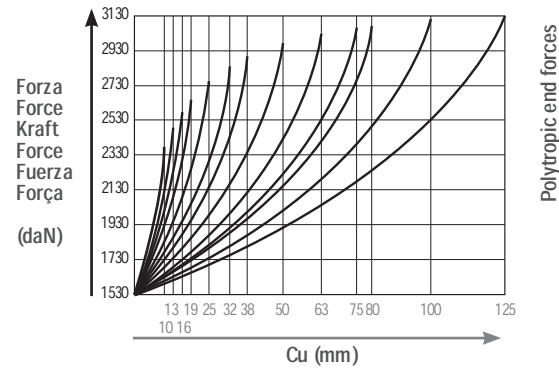
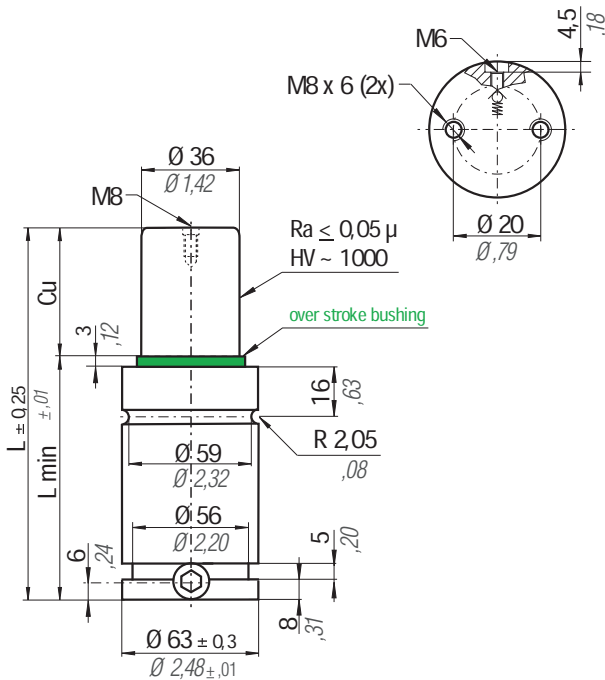

Max Speed 1,8m/s	°F 32 - 176	°C 0 - 80	N₂	P max 150bar 2175 psi	P min 20bar 290 psi	S 10,18cm ² 1,578 in ²		Maintenance kit 39BMRV01500A	
----------------------------	-----------------------------	---------------------------	----------------------	------------------------------------	----------------------------------	---	--	--	--

CODE	Cu		L		L min		F ₀		V ₀		CODE		
	mm	inch	mm	inch	mm	inch	daN	lb	cm ³	in ³	~Kg	~lb	
RV 1500 - 010 - A	10	0,39	64	2,52	54	2,13	1530	3440	41,8	2,55	0,90	1,98	RV 1500 - 010 - A - N
RV 1500 - 013 - A	13	0,51	70	2,76	57	2,24			49,8	3,04	0,92	2,03	RV 1500 - 013 - A - N
RV 1500 - 016 - A	16	0,63	76	2,99	60	2,36			57,8	3,53	0,96	2,12	RV 1500 - 016 - A - N
RV 1500 - 019 - A	19	0,75	82	3,23	63	2,48			65,8	4,01	0,99	2,18	RV 1500 - 019 - A - N
RV 1500 - 025 - A	25	0,98	94	3,70	69	2,72			81,7	4,98	1,06	2,34	RV 1500 - 025 - A - N
RV 1500 - 032 - A	32	1,26	108	4,25	76	2,99			100,2	6,11	1,14	2,51	RV 1500 - 032 - A - N
RV 1500 - 038 - A	38	1,50	120	4,72	82	3,23			116,2	7,09	1,21	2,67	RV 1500 - 038 - A - N
RV 1500 - 050 - A	50	1,97	144	5,67	94	3,70			148,0	9,03	1,35	2,98	RV 1500 - 050 - A - N
RV 1500 - 063 - A	63	2,48	170	6,69	107	4,21			182,5	11,13	1,51	3,33	RV 1500 - 063 - A - N
RV 1500 - 075 - A	75	2,95	194	7,64	119	4,69			214,4	13,08	1,65	3,64	RV 1500 - 075 - A - N
RV 1500 - 080 - A	80	3,15	204	8,03	124	4,88	227,7	13,89	1,71	3,77	RV 1500 - 080 - A - N		
RV 1500 - 100 - A	100	3,94	244	9,61	144	5,67	280,8	17,13	1,94	4,28	RV 1500 - 100 - A - N		
RV 1500 - 125 - A	125	4,92	294	11,57	169	6,65	347,1	21,17	2,23	4,92	RV 1500 - 125 - A - N		

Info pg. 231

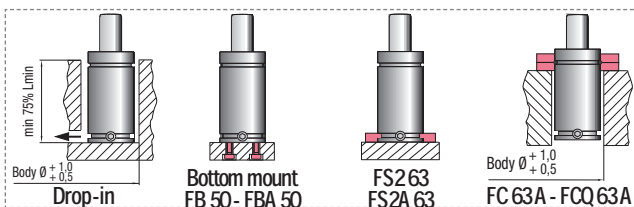

HOW TO ORDER

(10 pcs) RV 1500-050-A
(10 pcs) RV 1500-050-A-N

RV 2400



E24.54.815.G (PSA-Renault)
VDI 3003



Minima altezza, massima forza - Miniature height, maximum force -
Minimale Höhe, maximale Leistung - Hauteur -
Minima altura, máxima fuerza - Altura mínima, fuerza máxima

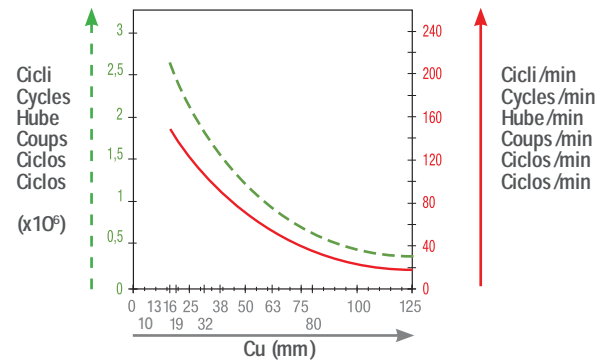
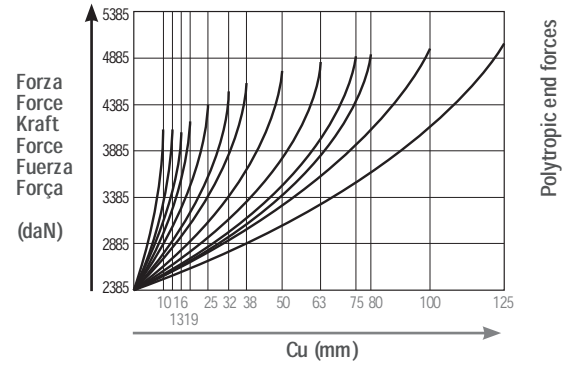
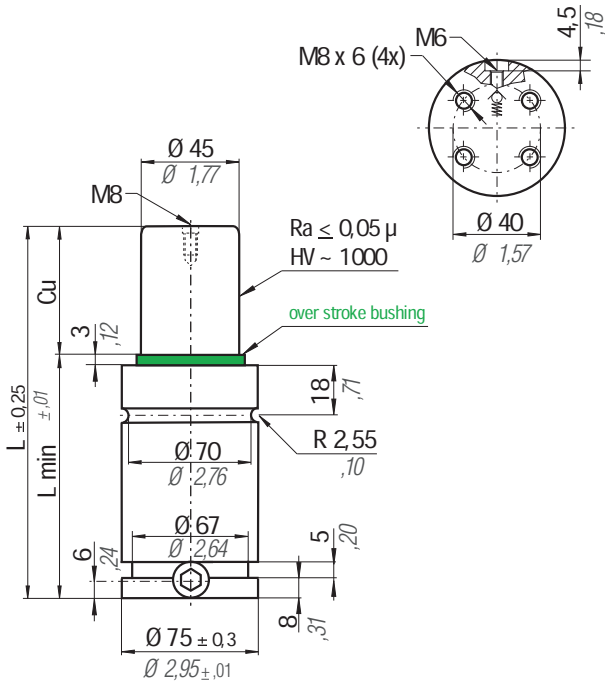

Max Speed 1,8m/s	°F 32 - 176	°C 0 - 80	N₂	P max 150bar 2175 psi	P min 20bar 290 psi	S 15,90cm ² 2,465 in ²		Maintenance kit 39BMRV02400A	
----------------------------	-----------------------------	---------------------------	----------------------	------------------------------------	----------------------------------	---	--	--	--

CODE	Cu		L		L min		F ₀		V ₀		CODE		
	mm	inch	mm	inch	mm	inch	daN	lb	cm ³	in ³	~Kg	~lb	
RV 2400 - 010 - A	10	0,39	65	2,56	55	2,17	2385	5362	64,0	3,91	1,27	2,80	RV 2400 - 010 - A - N
RV 2400 - 013 - A	13	0,51	71	2,80	58	2,28			76,2	4,65	1,36	3,00	RV 2400 - 013 - A - N
RV 2400 - 016 - A	16	0,63	77	3,03	61	2,40			88,3	5,39	1,36	3,00	RV 2400 - 016 - A - N
RV 2400 - 019 - A	19	0,75	83	3,27	64	2,52			100,4	6,13	1,40	3,09	RV 2400 - 019 - A - N
RV 2400 - 025 - A	25	0,98	95	3,74	70	2,76			124,5	7,60	1,50	3,31	RV 2400 - 025 - A - N
RV 2400 - 032 - A	32	1,26	109	4,29	77	3,03			152,7	9,32	1,61	3,55	RV 2400 - 032 - A - N
RV 2400 - 038 - A	38	1,50	121	4,76	83	3,27			176,8	10,79	1,70	3,75	RV 2400 - 038 - A - N
RV 2400 - 050 - A	50	1,97	145	5,71	95	3,74			225,1	13,74	1,89	4,17	RV 2400 - 050 - A - N
RV 2400 - 063 - A	63	2,48	171	6,73	108	4,25			277,5	16,93	2,09	4,61	RV 2400 - 063 - A - N
RV 2400 - 075 - A	75	2,95	195	7,68	120	4,72			325,8	19,88	2,28	5,03	RV 2400 - 075 - A - N
RV 2400 - 080 - A	80	3,15	205	8,07	125	4,92			345,9	21,11	2,36	5,20	RV 2400 - 080 - A - N
RV 2400 - 100 - A	100	3,94	245	9,65	145	5,71			426,4	26,02	2,67	5,89	RV 2400 - 100 - A - N
RV 2400 - 125 - A	125	4,92	295	11,61	170	6,69	527,0	32,16	3,07	6,77	RV 2400 - 125 - A - N		

Info pg. 231

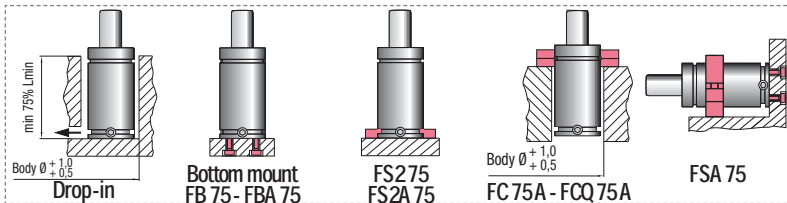

HOW TO ORDER
(10 pcs) RV 2400-050-A
(10 pcs) RV 2400-050-A-N

RV 4200



E24.54.815.G (PSA-Renault)
VDI 3003



Minima altezza, massima forza - Miniature height, maximum force -
Minimale Höhe, maximale Leistung - Hauteur -
Minima altura, máxima fuerza - Altura mínima, fuerza máxima

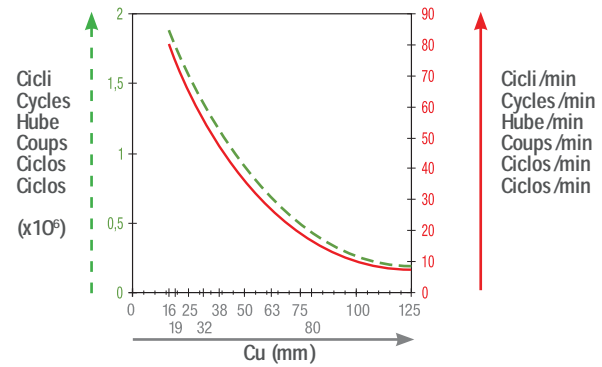
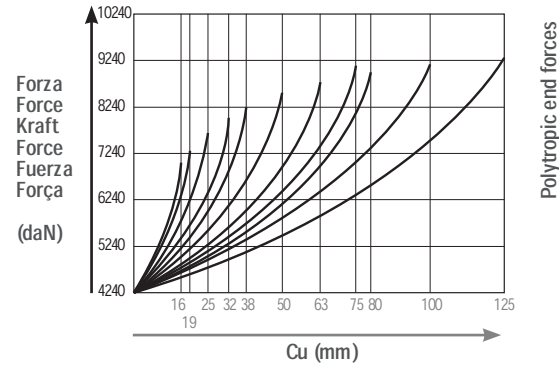
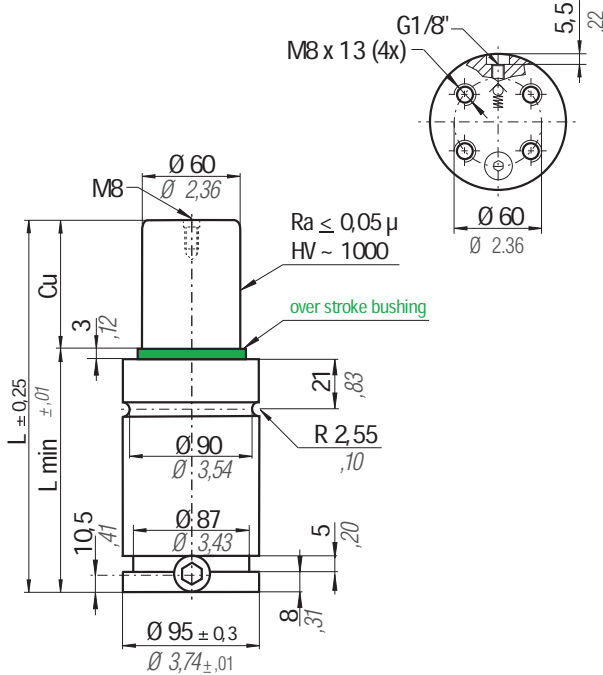

Max Speed 1,8m/s	°F 32 - 176	°C 0 - 80	N ₂	P max 150bar 2175 psi	P min 20bar 290 psi	S 28,27 cm ² 4,382 in ²		Maintenance kit 39BMRV04200A	
----------------------------	----------------------	--------------------	----------------	------------------------------------	----------------------------------	--	--	--	--

CODE	Cu		L		L min		Fo		Vo		CODE		
	mm	inch	mm	inch	mm	inch	daN	lb	cm ³	in ³	~Kg	~lb	
RV 4200 - 016 - A	16	0,63	90	3,54	74	2,91	4240	9532	164,7	10,05	2,76	6,08	RV 4200 - 016 - A - N
RV 4200 - 019 - A	19	0,75	96	3,78	77	3,03							RV 4200 - 019 - A - N
RV 4200 - 025 - A	25	0,98	108	4,25	83	3,27							RV 4200 - 025 - A - N
RV 4200 - 032 - A	32	1,26	122	4,80	90	3,54							RV 4200 - 032 - A - N
RV 4200 - 038 - A	38	1,50	134	5,28	96	3,78							RV 4200 - 038 - A - N
RV 4200 - 050 - A	50	1,97	158	6,22	108	4,25							RV 4200 - 050 - A - N
RV 4200 - 063 - A	63	2,48	184	7,24	121	4,76							RV 4200 - 063 - A - N
RV 4200 - 075 - A	75	2,95	208	8,19	133	5,24							RV 4200 - 075 - A - N
RV 4200 - 080 - A	80	3,15	218	8,58	138	5,43							RV 4200 - 080 - A - N
RV 4200 - 100 - A	100	3,94	258	10,16	158	6,22							RV 4200 - 100 - A - N
RV 4200 - 125 - A	125	4,92	308	12,13	183	7,20	RV 4200 - 125 - A - N						

Info pg. 231

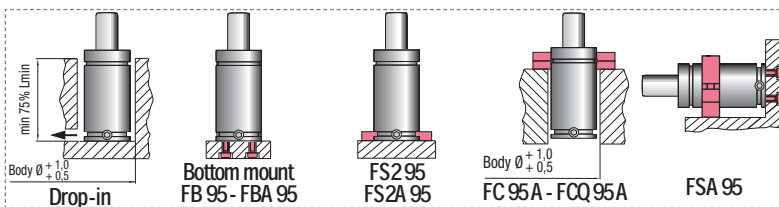

HOW TO ORDER

(10 pcs) RV 4200-050-A
(10 pcs) RV 4200-050-A-N

RV 6600



FIAT PED
Specification 97/23/EC

E24.54.815.G (PSA-Renault)
VDI 3003

Minima altezza, massima forza - Miniature height, maximum force -
Minimale Höhe, maximale Leistung/Hauteur -
Minima altura, máxima fuerza - Altura mínima, fuerza máxima

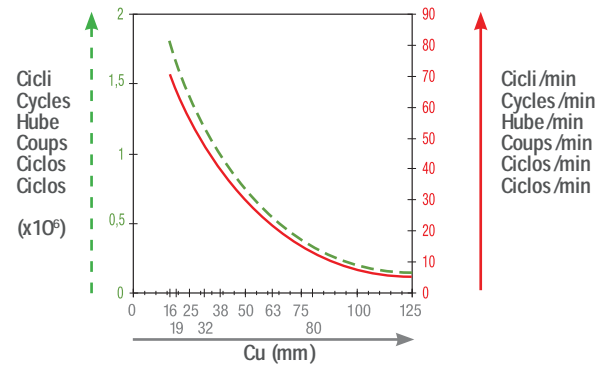
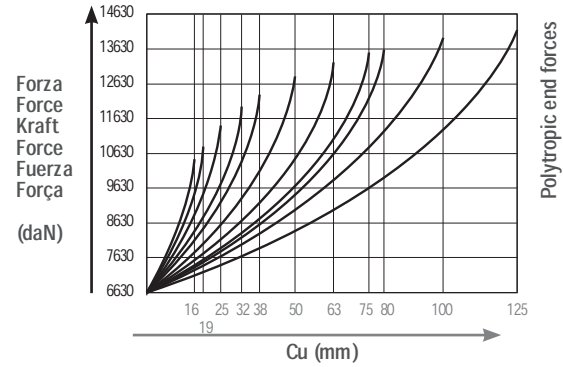
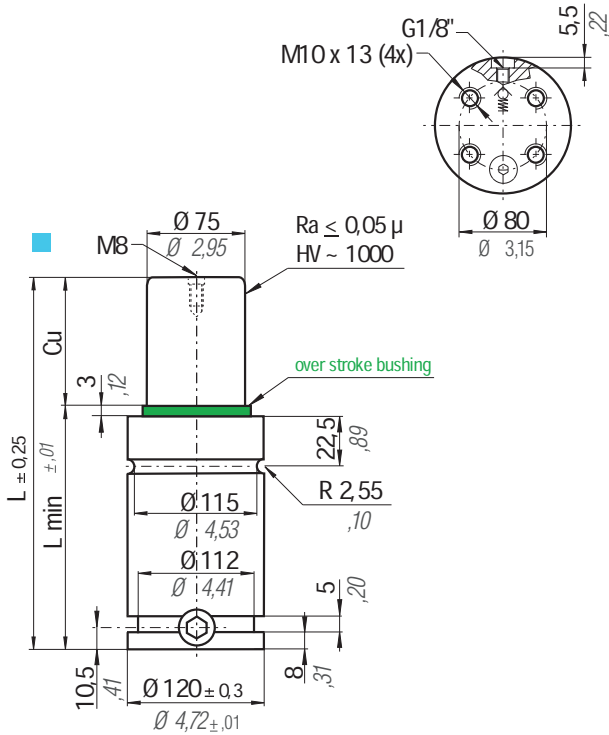

Max Speed 1,8m/s	°F 32 °C 0	°C 176 °F 80	N ₂	P max 150bar 2175 psi	P min 20bar 290 psi	S 44,18 cm ² 6,848 in ²		Maintenance kit 39BMRV06600A	
----------------------------	---------------	-----------------	----------------	------------------------------------	----------------------------------	--	--	--	--

CODE	Cu		L		L min		Fo		Vo		CODE			
	mm	inch	mm	inch	mm	inch	daN	lb	cm ³	in ³	~Kg	~lb		
RV 6600 - 016 - A	16	0,63	100	3,94	84	3,31	6630	14904	150bar 2175 psi	282,1	17,21	5,06	11,16	RV 6600 - 016 - A - N
RV 6600 - 019 - A	19	0,75	106	4,17	87	3,43				314,2	19,17	5,17	11,40	RV 6600 - 019 - A - N
RV 6600 - 025 - A	25	0,98	118	4,65	93	3,66				378,2	23,07	5,42	11,95	RV 6600 - 025 - A - N
RV 6600 - 032 - A	32	1,26	132	5,20	100	3,94				453,0	27,63	5,69	12,54	RV 6600 - 032 - A - N
RV 6600 - 038 - A	38	1,50	144	5,67	106	4,17				517,1	31,54	5,93	13,07	RV 6600 - 038 - A - N
RV 6600 - 050 - A	50	1,97	168	6,61	118	4,65				645,3	39,36	6,40	14,11	RV 6600 - 050 - A - N
RV 6600 - 063 - A	63	2,48	194	7,64	131	5,16				784,1	47,83	6,90	15,21	RV 6600 - 063 - A - N
RV 6600 - 075 - A	75	2,95	218	8,58	143	5,63				912,3	55,65	7,40	16,31	RV 6600 - 075 - A - N
RV 6600 - 080 - A	80	3,15	228	8,98	148	5,83				965,7	58,91	7,60	16,76	RV 6600 - 080 - A - N
RV 6600 - 100 - A	100	3,94	268	10,55	168	6,61				1179,4	71,94	8,40	18,52	RV 6600 - 100 - A - N
RV 6600 - 125 - A	125	4,92	318	12,52	193	7,60				1446,4	88,23	9,40	20,72	RV 6600 - 125 - A - N

Info pg. 231

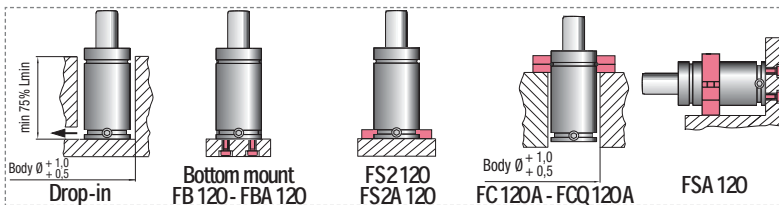

HOW TO ORDER

(10 pcs) RV 6600-050-A
(10 pcs) RV 6600-050-A-N

RV 9500



FIAT PED
Specification 97/23/EC

E24.54.815.G (PSA-Renault)
VDI 3003

Minima altezza, massima forza - Miniature height, maximum force -
Minimale Höhe, maximale Leistung/Hauteur -
Minima altura, máxima fuerza - Altura mínima, força máxima

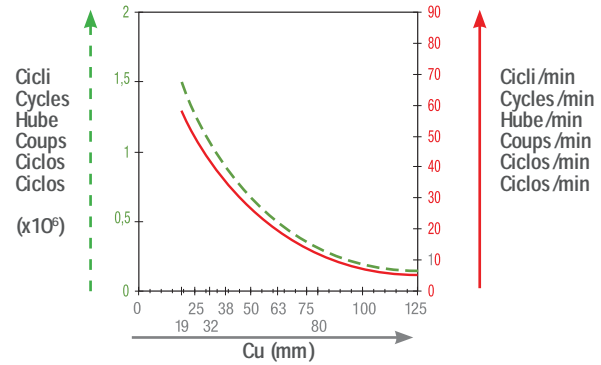
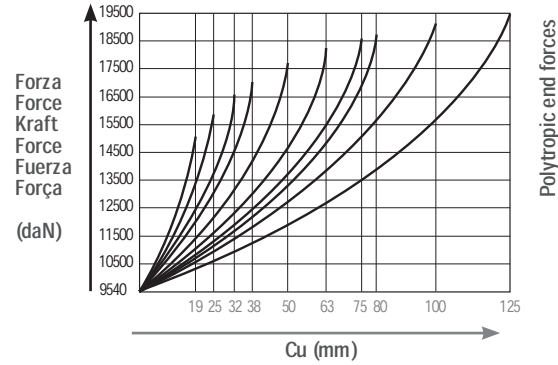
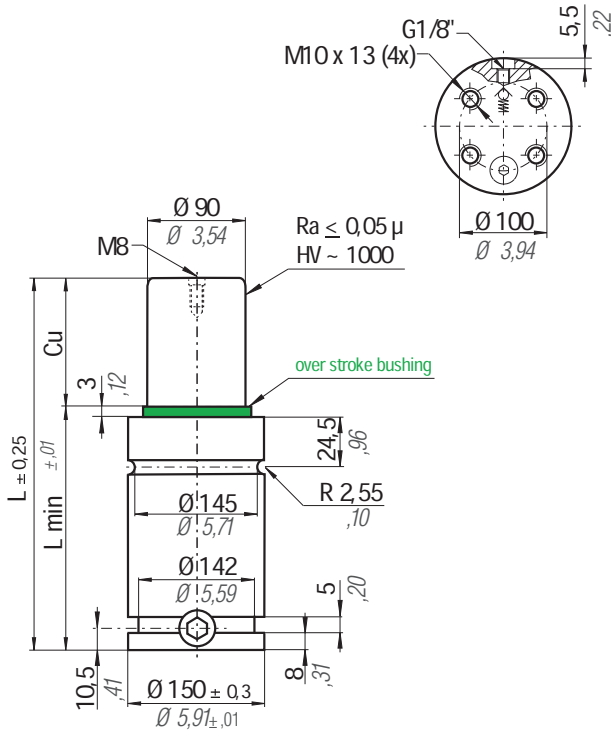

Max Speed 1,8m/s	°F 32 176	°C 0 -80		P max 150bar 2175 psi	P min 20bar 290 psi	S 63,62 cm ² 9,864 in ²		Maintenance kit 39BMRV09500A	
----------------------------	------------------------	-----------------------	--	------------------------------------	----------------------------------	--	--	--	--

CODE	Cu		L		L min		Fo		Vo		CODE		
	mm	inch	mm	inch	mm	inch	daN	lb	cm ³	in ³	~Kg	~lb	
RV 9500 - 019 - A	19	0,75	116	4,57	97	3,82	9540	2146	481,6	29,38	9,51	20,97	RV 9500 - 019 - A - N
RV 9500 - 025 - A	25	0,98	128	5,04	103	4,06			578,4	35,28	9,90	21,83	RV 9500 - 025 - A - N
RV 9500 - 032 - A	32	1,26	142	5,59	110	4,33			691,2	42,17	10,30	22,71	RV 9500 - 032 - A - N
RV 9500 - 038 - A	38	1,50	154	6,06	116	4,57			787,9	48,06	10,70	23,59	RV 9500 - 038 - A - N
RV 9500 - 050 - A	50	1,97	178	7,01	128	5,04			981,4	59,87	11,40	25,13	RV 9500 - 050 - A - N
RV 9500 - 063 - A	63	2,48	204	8,03	141	5,55			1190,9	72,64	12,20	26,90	RV 9500 - 063 - A - N
RV 9500 - 075 - A	75	2,95	228	8,98	153	6,02			1384,4	84,45	13,00	28,66	RV 9500 - 075 - A - N
RV 9500 - 080 - A	80	3,15	238	9,37	158	6,22			1465,0	89,37	13,30	29,32	RV 9500 - 080 - A - N
RV 9500 - 100 - A	100	3,94	278	10,94	178	7,01			1787,4	109,03	14,60	32,19	RV 9500 - 100 - A - N
RV 9500 - 125 - A	125	4,92	328	12,91	203	7,99			2190,4	133,61	16,10	35,49	RV 9500 - 125 - A - N

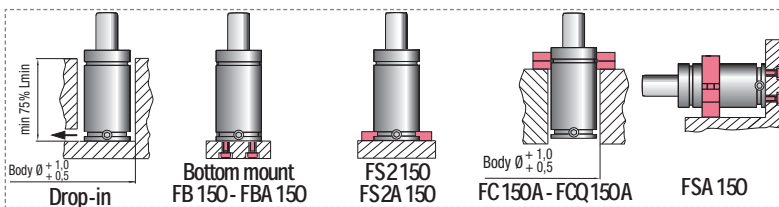

HOW TO ORDER

(10 pcs) RV 9500-050-A
(10 pcs) RV 9500-050-A-N