

3 Type

- O** Without spring-loaded return
- L** Spring-loaded return, left
- R** Spring-loaded return, right

4 Identification no.

- 1** Light spring load
- 2** Heavy spring load

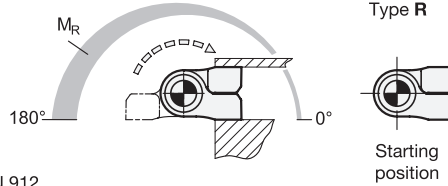
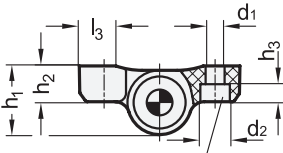

Bore for socket cap screw DIN 912

1 **2**

l ₁	l ₂	d ₁	d ₂	h ₁	h ₂	h ₃	l ₃	m ₁	m ₂	Max. restoring torque M _R in Nm	
										Identification no. 1	Identification no. 2
55	67	6,5	10	24	12,5	6,3	12,5	38	48	0,35	0,7

Specification

5

- Plastic (Polyamide PA-HP)
 - Glass fiber reinforced
 - Temperature resistant up to 60 °C
 - Black, matte finish **● SW**
- Pin
Aluminum
- Shaft cover
Plastic (Polyacetal POM)
Black
- Torsion spring
Stainless steel
- *Load Rating Information* → Page 2126
- *Plastic Characteristics* → Page 2158
- RoHS

Information

Hinges GN 233.3 with spring-loaded return allow doors to be automatically opened and closed by means of the torsion spring.

The restoring torque varies with the opening angle of the hinge. Endurance tests have shown that the torque does not change even after 100,000 opening / closing cycles.

The following table shows the relationship between the opening angle and restoring torque. The indicated maximum opening angle should not be exceeded.

Restoring torque M _R in Nm (Type L)				Restoring torque M _R in Nm (Type R)		
Id. no.	0°	90°	270°	Id. no.	0°	180°
1	0	0,12	0,35	1	0,12	0,35
2	0	0,25	0,7	2	0,25	0,7

see also...

- *List of Hinge Types* → Page 1284

How to order (Without spring-loaded return)

1	l ₁
2	l ₂
3	Type
5	Color

GN 233.3-55-67-O-SW

How to order (With spring-loaded return)

1	l ₁
2	l ₂
3	Type
4	Identification no.
5	Color

GN 233.3-55-67-R-1-SW

