

Installation

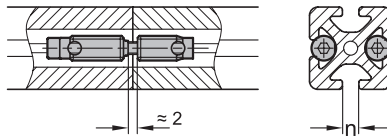

2 Profile type

S Heavy

3 Coding

S End face connection

Use

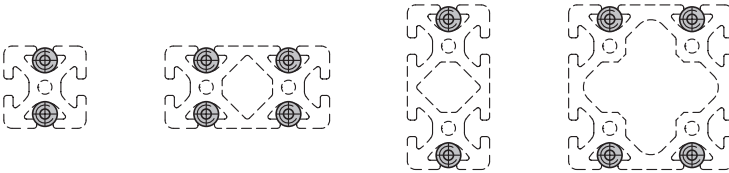

1

5

n	Bundle Pieces	d ₁ Self-forming thread	d ₂	l ₁	l ₂	l ₃	A/F ₁	A/F ₂	Tightening torque in Nm
6	4	S 10	M 5	32	-	27	4	5	8
8	4	S 12	M 6	34,5	2,5	30,8	5	6	14

Specification

- Steel, zinc plated, blue passivated
- RoHS

4

SZ

Information

Automatic connectors GN 23i fasten aluminum profiles together on the end faces to extend them while securing them against twisting. Machining of the profile is not necessary.

For assembly, first insert the socket cap screw along the slot and then screw in the lightly lubricated threaded bushings. Minor burr formation is possible. Automatic connectors are used in pairs opposite each other. If panels are used in the slot, they must be suitably pocketed.

Automatic connectors are supplied in bundles. The table shows the quantity included in each bundle.

see also...

- Aluminum Profiles GN 10i (Profile Type Light) → Page QVX
- Aluminum Profiles GN 10i (Profile Type Heavy) → Page QVX
- Aluminum Profiles GN 11i (with Partially Closed Slots) → Page QVX

How to order

GN 23i - 8 S - S - SZ - 4

1	n
2	Profile type
3	Coding
4	Material / Finish
5	Bundle



Assembly Instructions

