

Installation holes

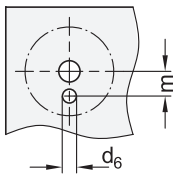

Application examples

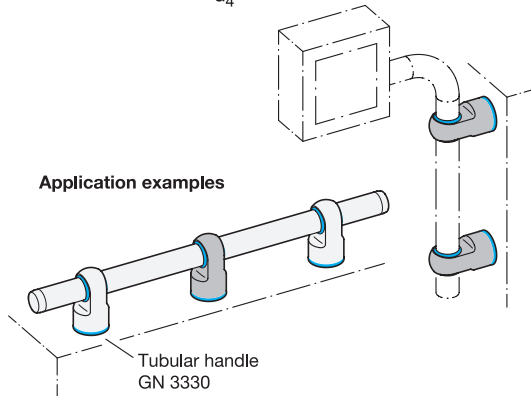

Tubular handle GN 3330

2

3

d ₁ For rod / tube	h ₁	b	d ₂	d ₃	d ₄	d ₅	d ₆	h ₂	m	A/F	t min.
30 +0,1 / -0,25	60	27,5	M 10	46	46,6	42	8	84	13,5	5	20
40 +0,15 / -0,3	70	30	M 12	56	56,8	50	8	99	18,5	5	25

Specification

- Stainless steel AISI 304 **NI**
Matte finish (Ra < 0.8 µm) **MT**
- Sealing ring and wiper **T**
TPU
- Blue
- Temperature resistant -20 °C to +110 °C
- Hardness 95 ±5 Shore A
- FDA compliant
- Clamping wedge
Brass
- Grub screw
Stainless steel
- Plastic Characteristics → Page QVX
- Stainless Steel Characteristics → Page QVX
- RoHS

1 4 5

Information

Handle legs GN 3331 are intended for use in hygienic areas. The sealed mounting surface enables fastening without dead spaces. The high quality finish as well as the non-concave geometry prevent adherence of dirt and facilitate cleaning.

The handle legs are designed for use with tubular handles GN 3330 to reduce large distances between mounting points or excessive loads on the handle legs. Regardless of the handle application, supports can be used to fix rods and tubes with the corresponding diameter d₁. The tube or rod is fastened during installation using the integrated clamping wedge.

see also...

- Product Family *Hygienic Design* → Page QVX
- Tubular Handles GN 3330 (Stainless Steel, *Hygienic Design*) → Page QVX

Accessory

- Screws GN 1580 → Page QVX
- Screws GN 1581 → Page QVX

How to order

1	Material
2	d ₁
3	h ₁
4	Finish
5	Material (seals)

GN3331-NI-40-70-MT-T

