

2 Type

- DK** With triangular spindle
- VK7** With square spindle
- VK8** With square spindle
- SCH** With slot
- VDE** With double bit

Type **DK**

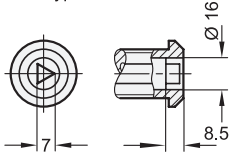

Type **VK7 / VK8**

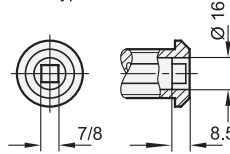

Type **SCH**

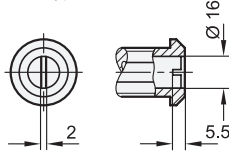

Type **VDE**

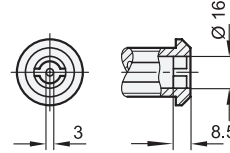

3

4

| h₁ | Latch arm distance A | | | | | | | | | | | h₂ | s max. |
|----------------------|-----------------------------|----|----|----|----|----|----|----|----|----|----|----------------------|---------------|
| 30 | 16 | 20 | 25 | 28 | 32 | 36 | 40 | 44 | 48 | 52 | 57 | 40 | 20 |
| 30 | 18 | 22 | 26 | 30 | 34 | 38 | 42 | 46 | 50 | 54 | 62 | 40 | 20 |
| 40 | 26 | 30 | 35 | 38 | 42 | 46 | 50 | 54 | 58 | 62 | 67 | 50 | 30 |
| 40 | 28 | 32 | 36 | 40 | 44 | 48 | 52 | 56 | 60 | 64 | 72 | 50 | 30 |
| 50 | 36 | 40 | 45 | 48 | 52 | 56 | 60 | 64 | 68 | 72 | 77 | 60 | 40 |
| 50 | 38 | 42 | 46 | 50 | 54 | 58 | 62 | 66 | 70 | 74 | 82 | 60 | 40 |
| 60 | 46 | 50 | 55 | 58 | 62 | 66 | 70 | 74 | 78 | 82 | 87 | 70 | 50 |
| 60 | 48 | 52 | 56 | 60 | 64 | 68 | 72 | 76 | 80 | 84 | 92 | 70 | 50 |

Specification

1

5

- Lock housing
Zinc die casting **ZD**
Housing collar
Powder coated
Black, RAL 9005, textured finish **● SW**
- Other parts
Steel, zinc plated, blue passivated
- Protection class IP65
- IP Protection Classes → Page QVX
- RoHS

Accessory

- Socket Keys GN 119.2 → Page QVX
- Opening Handles GN 120.1 → Page QVX
- Protective Guide Plates GN 120.2 → Page QVX

Information

Latches GN 515 are identical to standard latches GN 115 except for the extended housing. They are operated with a rotation limited to 90°, which moves the latch arm into the locked position behind the frame. The bevels of the latch arm ease the closing of the door.

By installing latch arms with different bend profiles, the latch distance A can be varied from 16 to 92 mm depending on the housing height h₁, while the extended housing is suitable for a door thickness s up to 50 mm.

Latches GN 515 are supplied with loosely enclosed latch arm.

How to order

| | |
|----------|-----------------------------|
| 1 | Material |
| 2 | Type |
| 3 | h₁ |
| 4 | Latch arm distance A |
| 5 | Finish |

GN 515-ZD-VK8-30-22-SW

