

**1 Type**

- Operation
- SG** with star knob
- SK** with wrench
- ST** with T-Handle
- RG** with knurled knob (GN 7336)
- KG** with wrench
- HG** with lever



**3 Version of the hook**

- H1** Pivot radius R=28

**5 Identification no.**

- 1** without latch bracket
- 2** with latch bracket

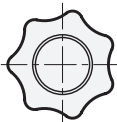

Type **SG**

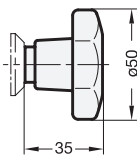

Type **SK**

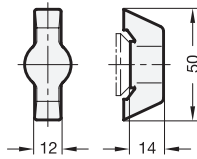

Type **ST**

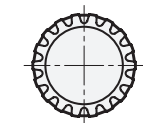
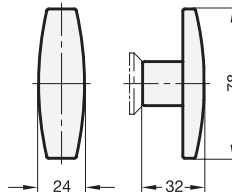

Type **RG**

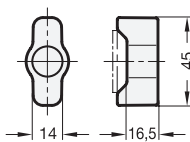
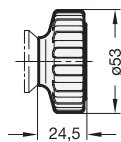

Type **KG**

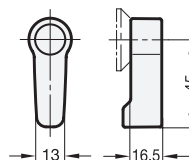

Type **HG**

**2**

Hook distance <b>A</b>	<b>d</b> Type SG, RG, KG, HG	Type SK, ST	<b>h</b> Type SG, RG, KG, HG	Type SK, ST
18	28	32	4	6

1) Dimensions of the latch bracket → Page XYZ.

**Specification**

- Lock housing  
Zinc die casting
- Locating ring  
- chrome plated **CR**  
- plastic coated **SW**  
black, RAL 9005, textured finish
- All other parts  
Steel zinc plated, blue passivated
- Operating handles  
Plastic (Polyamide PA)  
black, matt
- Cover cap (type RG, KG, HG)  
light grey

• **RoHS compliant**

**On request**

- Hook-type latches  
with other hook distance A
- Hook with other pivoting radius R

**4**

**Information**

Hook-type latches GN 115.8 with hook and latch bracket are mainly used for sliding doors and flaps. The locking action is in radial direction to the axis of rotation, resulting in a wide variety of different uses.

Hook-type latches GN 115.8 are supplied with the hook enclosed loose.

Further construction and assembly instructions → Page XYZ.

siehe auch...

- *Hook-type latches GN 115.8 (Operation with key) → New products*
- *Hook-type latches GN 115.8 (lockable) → New products*

**How to order**

<b>1</b>	<b>Type</b>
<b>2</b>	<b>Latch distance A</b>
<b>3</b>	<b>Version of the hook</b>
<b>4</b>	<b>Finish of the locating ring</b>
<b>5</b>	<b>Identification no.</b>

**GN 115.8-HG-18-H1-SW-2**